

TYPE "2KW6" VERTICALLY RESTRAINED SPRING ISOLATOR

9/16" DIA. HOLE

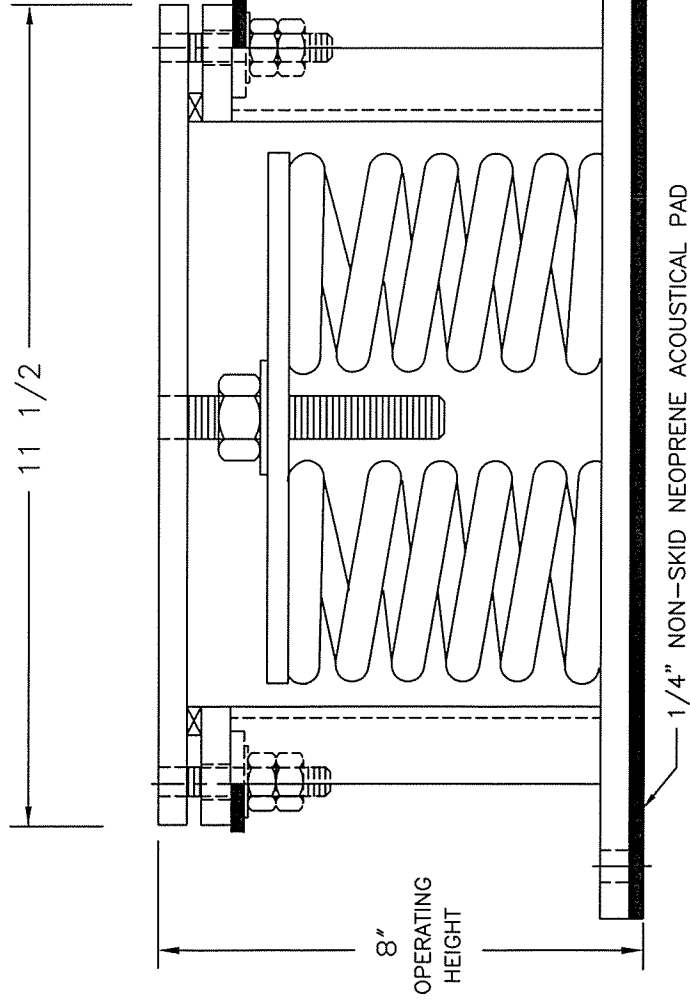

ISOLATOR TYPE	COLOR CODE	RATED LOAD	RATED DEFL.
2KW6 { F66 F67 F68 F69 F69/N60 }	Gold	1000 #	2.00"
	White	1430 #	2.00"
	Red/White	1890 #	2.00"
	Red/Yellow	2380 #	2.00"
	Red/Silver	4080 #	2.00"

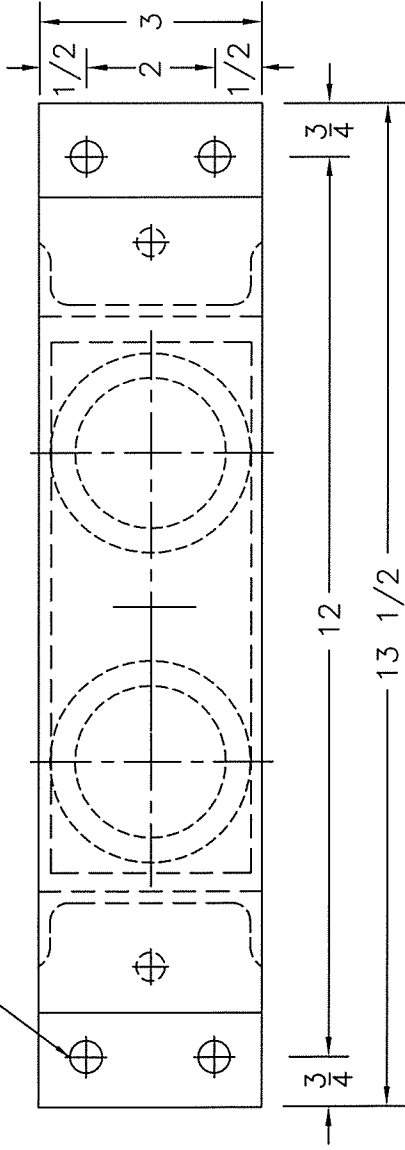
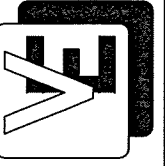

C2000/2KV6-SM.DWG.

VIBRATION ELIMINATOR CO. INC.

15 Dixon Avenue

Copiapue, NY 11726

PH. (516)841-4000 FAX (516)841-0020

JOB : _____
 CONTRACTOR : _____
 P.O. NO. : _____

Dwg. No. _____